

SEVENTH ELEMENT

Parts



De Creo Perfectio



Seventh Element

The "Seventh Element" logo is either registered trademarks, trademarks, or design trademarks of Seventh Element, Inc.

www.theseventhelement.com

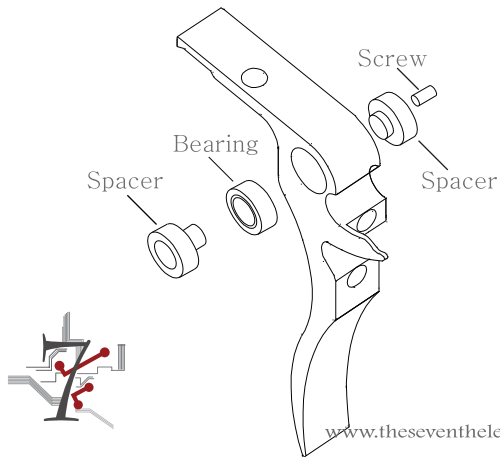

Installation

1. Please refer to your original manual for instruction on removal of stock trigger assembly.
2. Place the two spacers on each side of the trigger.
3. Guide the trigger into the grip frame trigger slot
4. Place the screw into the frame. This is the opposite side of where you place the battery. The right side.
5. Check to make sure the trigger movement is free after the installation.
6. Make sure the microswitch actuating screw is reaching the microswitch and actuating.

www.theseventhelement.com